

PROPOSED CLUSTER SUBDIVISION OF LAND FOR

JIM AND SUZANNE HOOPER

46 REYNOLDS ROAD
MOREAU, NY 12828

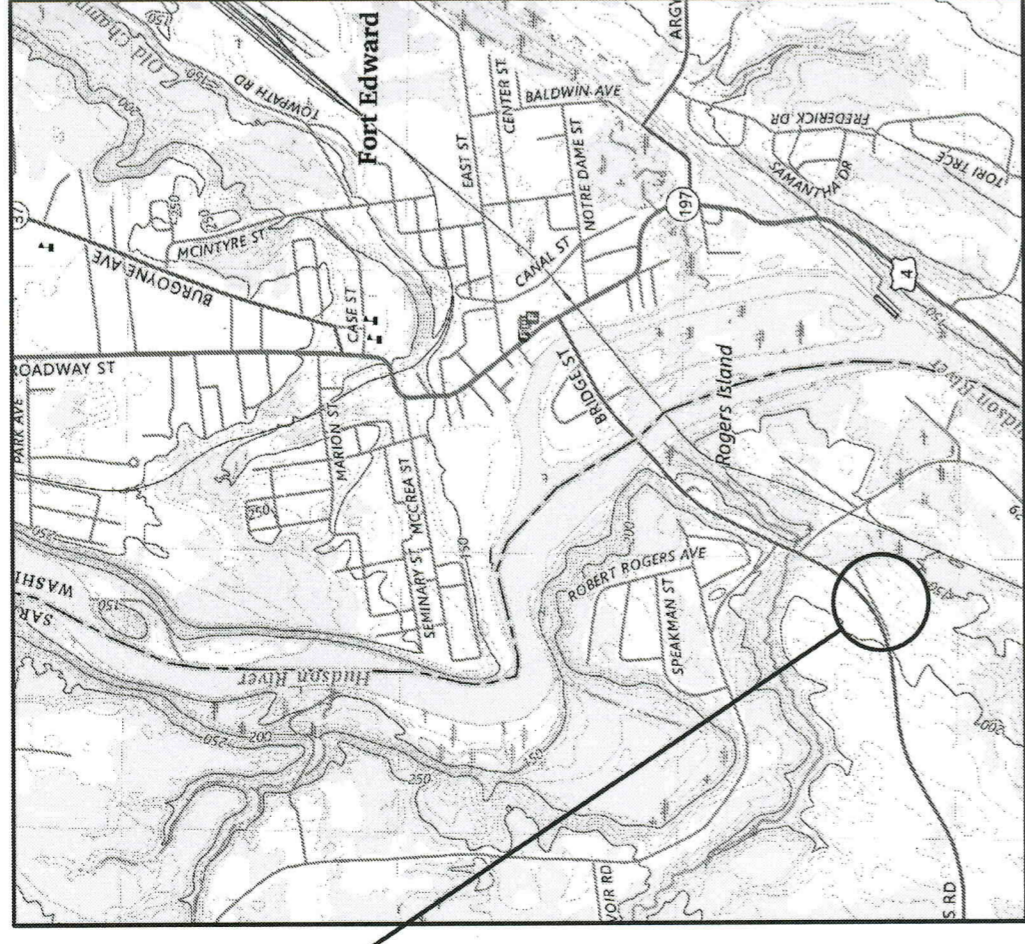

PROJECT LOCATION

ENGINEER:

Daniel J. Gosselin, PE
PO BOX 405
Gansevoort, NY 12831
(518) 744-0047
gosselin.daniel@live.com

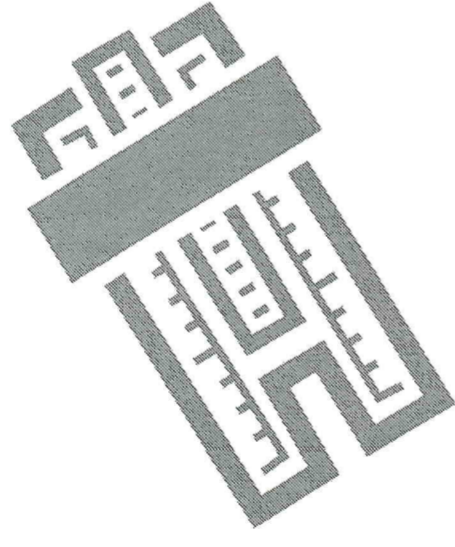

SURVEYOR:

Russell Howard, LS
342 Main Street
Hudson Falls, NY 12839
(518) 747-8747
gosselin.daniel@live.com

DRAWING INDEX			
DRAWING #	SHEET #	DRAWING NAME	REVISION
S-101	1	EXISTING PROPERTY LAYOUT AND FEATURES	0
S-102	2	PROPOSED GENERAL SITE DISTURBANCE PLAN	0
S-103	3	DRIVEWAY AND GENERAL DRAINAGE DETAILS	0
S-103	4	PROPOSED GENERAL SEPTIC DETAILS & NOTES	0
S-105	5	EROSION & SEDIMENT CONTROL DETAILS	0

PROJECT LOCATION MAP
SCALE: N.T.S.

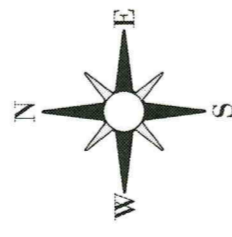

FILE COPY

RECEIVED

JAN 06 2025

TOWN OF MOREAU
BUILDING DEPARTMENT



IT IS A VIOLATION OF NEW YORK STATE EDUCATION LAW FOR ANY PERSON UNLESS HE OR SHE IS A LICENSED PROFESSIONAL ENGINEER, ARCHITECT, LANDSCAPE ARCHITECT, OR LAND SURVEYOR, TO ALTER ANY ITEM IN ANY WAY. IF AN ITEM BEARING THE STAMP OF A LICENSED PROFESSIONAL IS ALTERED, THE ALTERING LICENSED PROFESSIONAL SHALL BE RESPONSIBLE FOR THE ALTERATION. THE SEAL SHALL BE ALTERED BY FOLLOWING BY THEIR SIGNATURE, THE DATE OF SUCH ALTERATION, AND SPECIFIC DESCRIPTION OF THE ALTERATION.

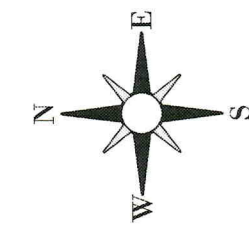

LEGEND

- PROPERTY LINE
- PROPERTY SETBACK LINE
- EXISTING MAJOR CONTOUR
- EXISTING MINOR CONTOUR
- LIMITS OF DISTURBANCE
- FEDERAL WETLANDS

EXISTING PROPERTY LAYOUT AND FEATURES

SCALE: 1" = 80'

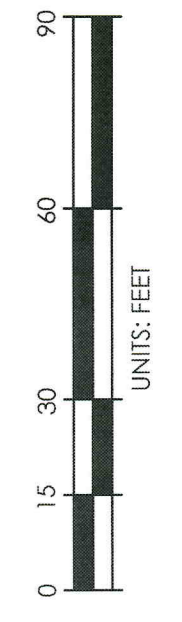

Notes:

IT IS A VIOLATION OF NEW YORK STATE EDUCATION LAW FOR ANY PERSON, UNLESS THEY ARE ACTING UNDER THE AUTHORITY OF A LICENSED PROFESSIONAL ENGINEER, ARCHITECT, LAND SURVEYOR, OR LAND SURVEYOR TO ALTER ANY ITEM IN ANY WAY, IF AN ITEM BEARING THE STAMP OF A LICENSED PROFESSIONAL IS ALTERED. THE ALTERING LICENSED PROFESSIONAL SHALL STAMP THE DOCUMENT AND INCLUDE THE NOTATION "ALTERED BY" FOLLOWED BY THEIR SIGNATURE, THE DATE OF SUCH ALTERATION, AND SPECIFIC DESCRIPTION OF THE ALTERATION.

REV: DESCRIPTION: BY: DATE:
 STATUS: FOR REVIEW

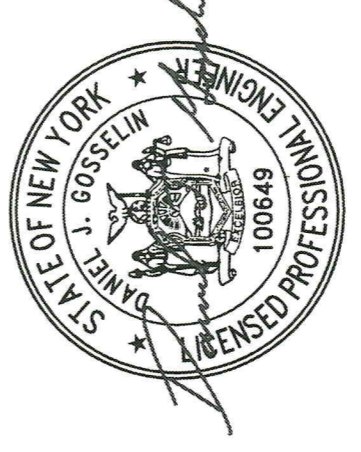

Daniel J. Gosselin, PE
 P.O. BOX 405
 CORSEWICK, NY 12831
 (518) 744-0047
 gosselin.daniel@live.com

CLIENT:
JIM & SUZANNE HOOPER
 46 Reynolds Road
 Moreau, Saratoga County, NY 12828

SURVEYOR:
Russell Howard, LS
 342 Main Street
 Hudson Falls, NY 12839

SITE:		Cluster Subdivision	
TITLE:		Tax Map ID: 64-2-106.1	
TITLE:		EXISTING PROPERTY LAYOUT AND FEATURES	
SCALE:	DATE:	DRAWN:	CHECKED:
AS SHOWN	11/30/2024	D.J.G.	S.F.G.
PROJECT NO.:	DRAWING NO.:	REVISION:	
24.262	S-101	0	

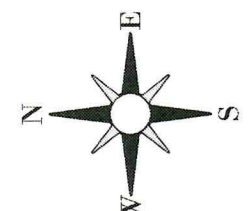

Notes:

IT IS A VIOLATION OF NEW YORK STATE EDUCATION LAW FOR ANY PERSON, UNLESS THEY ARE ACTING UNDER THE AUTHORITY OF A LICENSED PROFESSIONAL ENGINEER, ARCHITECT, LANDSCAPE ARCHITECT, SURVEYOR, OR ANOTHER LICENSED PROFESSIONAL, TO ALTER ANY ITEM IN ANY WAY, IF AN ITEM BEARING THE STAMP OF A LICENSED PROFESSIONAL IS ALTERED. THE ALTERING LICENSED PROFESSIONAL SHALL STAMP THE DOCUMENT AND INCLUDE THE NOTATION "ALTERED BY FOLLOWED BY THEIR SIGNATURE, THE DATE OF ALTERATION, AND SPECIFIC DESCRIPTION OF THE ALTERATION."

ASSUMED LIMITS OF DISTURBANCE FOR LOT 3. AREA = 0.171 ACRES

PROPOSED 12'-0" WIDE RESIDENTIAL DRIVEWAY. SEE DETAILS ON SHEET S-103.

PROPOSED RESIDENCE. ASSUMED FOOTPRINT AREA 800 SF. APPROX. FLOOR EL. 186'-30"

ASSUMED 880 SF SEPTIC FIELD. SEE GENERAL DETAILS AND NOTES ON SHEET S-104.

ASSUMED LIMITS OF DISTURBANCE FOR LOT 3. AREA = 0.161 ACRES

PROPOSED 12'-0" WIDE RESIDENTIAL DRIVEWAY. SEE DETAILS ON SHEET S-103.

PROPOSED RESIDENCE. ASSUMED FOOTPRINT AREA 800 SF. APPROX. FLOOR EL. 198'-30"

ASSUMED 880 SF SEPTIC FIELD. SEE GENERAL DETAILS AND NOTES ON SHEET S-104.

PROPOSED 15'-0" WIDE SHARED RESIDENTIAL DRIVEWAY. SEE DETAILS ON SHEET S-103.

REPLACE EXISTING CULVERT WITH 18 INCH DIAMETER HOPE SMOOTH WAL PIPE. LENGTH = 35.00' INLET INVERT ELEVATION = 193.00' OUTLET INVERT ELEVATION = 192.30' SEE DETAIL ON SHEET S-104.

ASSUMED LIMITS OF DISTURBANCE FOR LOT 1/2. AREA = 0.948 ACRES

PROPOSED 12'-0" WIDE RESIDENTIAL DRIVEWAY. SEE DETAILS ON SHEET S-103.

PROPOSED RESIDENCE. ASSUMED FOOTPRINT AREA 800 SF. APPROX. FLOOR EL. 178'-00"

ASSUMED 880 SF SEPTIC FIELD. SEE GENERAL DETAILS AND NOTES ON SHEET S-104.

APPROX. EXTENT OF FEDERAL WETLANDS NO. PFO1E

APPROX. EXTENT OF FEDERAL WETLANDS NO. PFO1E

APPROX. EXTENT OF FEDERAL WETLANDS NO. PFO1E

PROPERTY LINE

EXISTING MAJOR CONTOUR

EXISTING MINOR CONTOUR

PROPOSED CONTOUR

SILT FENCE OR BIO-FIBER ROLL

CONSTRUCTION ENTRANCE

LIMITS OF DISTURBANCE

FEDERAL WETLANDS

ASSUMED LIMITS OF DISTURBANCE FOR LOT 3. AREA = 0.171 ACRES

PROPOSED 12'-0" WIDE RESIDENTIAL DRIVEWAY. SEE DETAILS ON SHEET S-103.

PROPOSED RESIDENCE. ASSUMED FOOTPRINT AREA 800 SF. APPROX. FLOOR EL. 186'-30"

ASSUMED 880 SF SEPTIC FIELD. SEE GENERAL DETAILS AND NOTES ON SHEET S-104.

ASSUMED LIMITS OF DISTURBANCE FOR LOT 3. AREA = 0.161 ACRES

PROPOSED 12'-0" WIDE RESIDENTIAL DRIVEWAY. SEE DETAILS ON SHEET S-103.

PROPOSED RESIDENCE. ASSUMED FOOTPRINT AREA 800 SF. APPROX. FLOOR EL. 198'-30"

ASSUMED 880 SF SEPTIC FIELD. SEE GENERAL DETAILS AND NOTES ON SHEET S-104.

PROPOSED 15'-0" WIDE SHARED RESIDENTIAL DRIVEWAY. SEE DETAILS ON SHEET S-103.

REPLACE EXISTING CULVERT WITH 18 INCH DIAMETER HOPE SMOOTH WAL PIPE. LENGTH = 35.00' INLET INVERT ELEVATION = 193.00' OUTLET INVERT ELEVATION = 192.30' SEE DETAIL ON SHEET S-104.

ASSUMED LIMITS OF DISTURBANCE FOR LOT 1/2. AREA = 0.948 ACRES

PROPOSED 12'-0" WIDE RESIDENTIAL DRIVEWAY. SEE DETAILS ON SHEET S-103.

PROPOSED RESIDENCE. ASSUMED FOOTPRINT AREA 800 SF. APPROX. FLOOR EL. 178'-00"

ASSUMED 880 SF SEPTIC FIELD. SEE GENERAL DETAILS AND NOTES ON SHEET S-104.

APPROX. EXTENT OF FEDERAL WETLANDS NO. PFO1E

LEGEND

PROPERTY LINE

EXISTING MAJOR CONTOUR

EXISTING MINOR CONTOUR

PROPOSED CONTOUR

SILT FENCE OR BIO-FIBER ROLL

CONSTRUCTION ENTRANCE

LIMITS OF DISTURBANCE

FEDERAL WETLANDS

PROPOSED SITE DISTURBANCE PLAN

SCALE: 1" = 80'

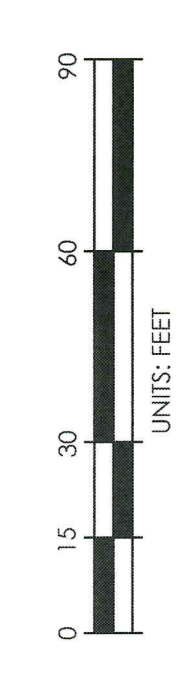

REV.	DESCRIPTION	BY:	DATE:

STATUS: FOR REVIEW



Daniel J. Gosselin, PE
 PO BOX 405
 Coarseville, NY 12831
 (518) 744-0047
 gosselin.daniel@live.com

JIM & SUZANNE HOOPER
 46 Reynolds Road
 Moreau, Saratoga County, NY 12828

SITE:	Cluster Subdivision Tax Map ID: 64-2-106.1 Moreau, NY
TITLE:	PROPOSED GENERAL SITE DISTURBANCE PLAN
SCALE:	AS SHOWN
DATE:	11/30/2024
PROJECT NO.:	24,262
DRAWN:	D.J.G.
CHECKED:	S.F.G.
BRANNING NO.:	S-102
REVISION:	

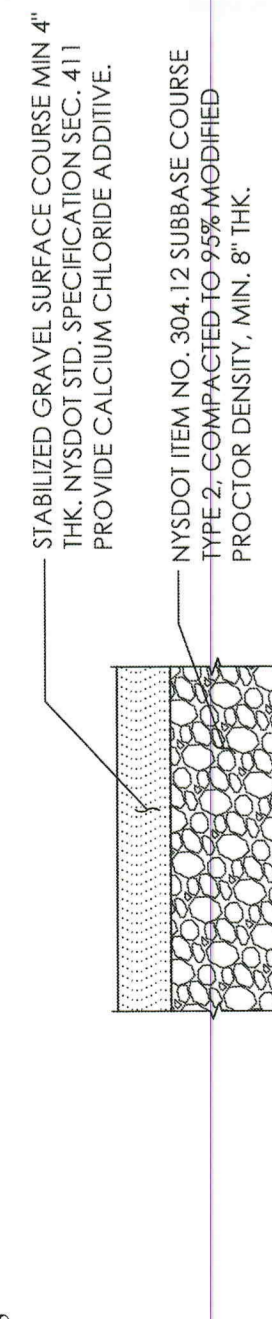
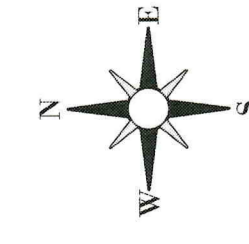

TYPICAL GRAVEL PARKING/DRIVE DETAIL
N.T.S.

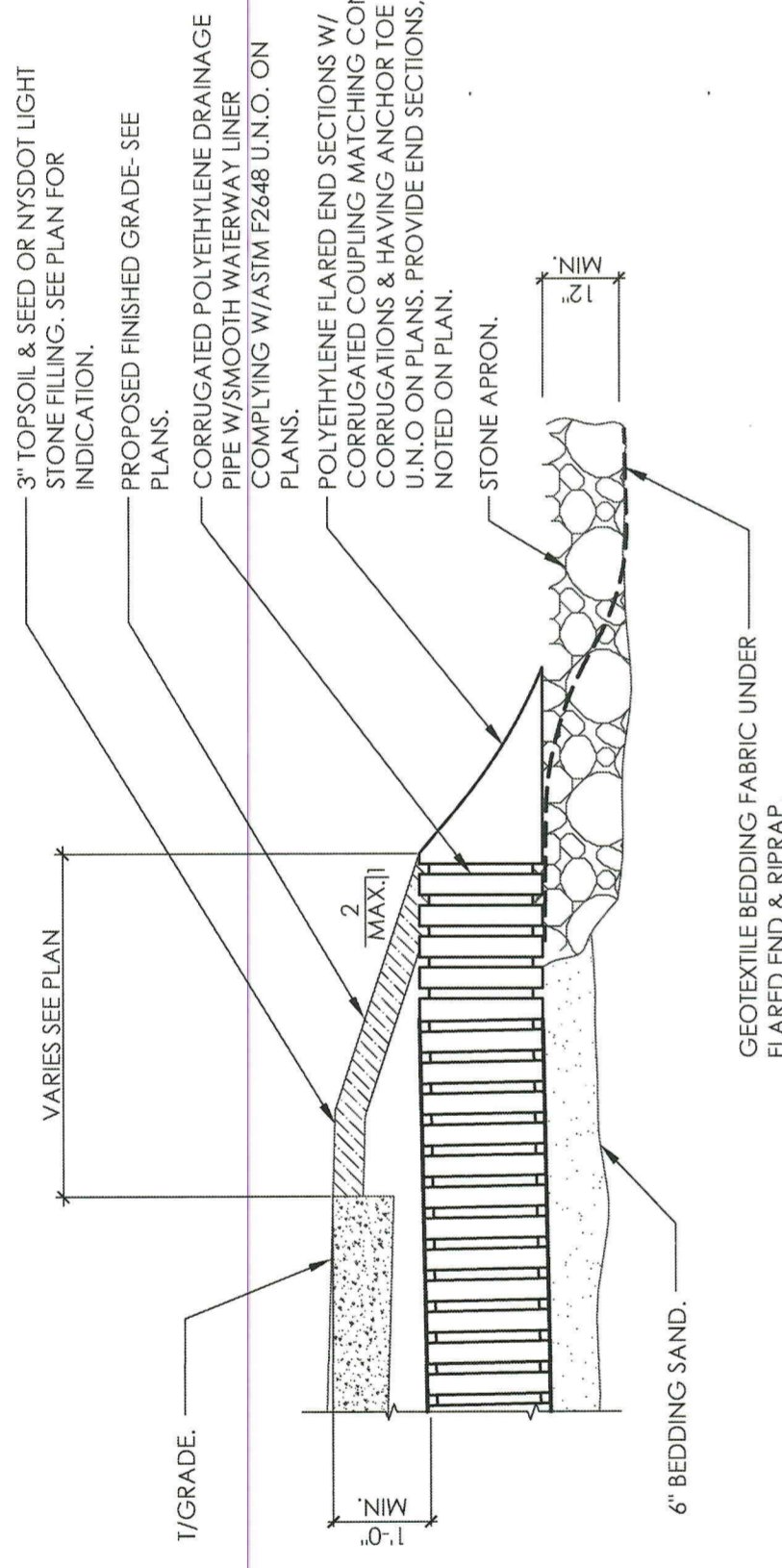

TYPICAL CULVERT DETAIL
N.T.S.

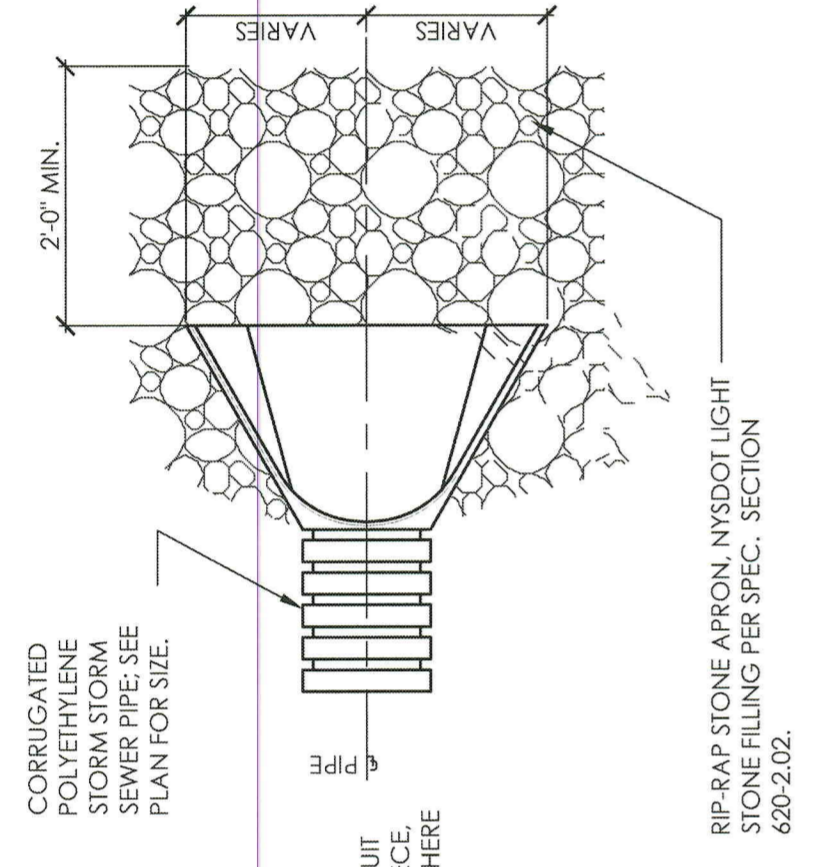

PLAN

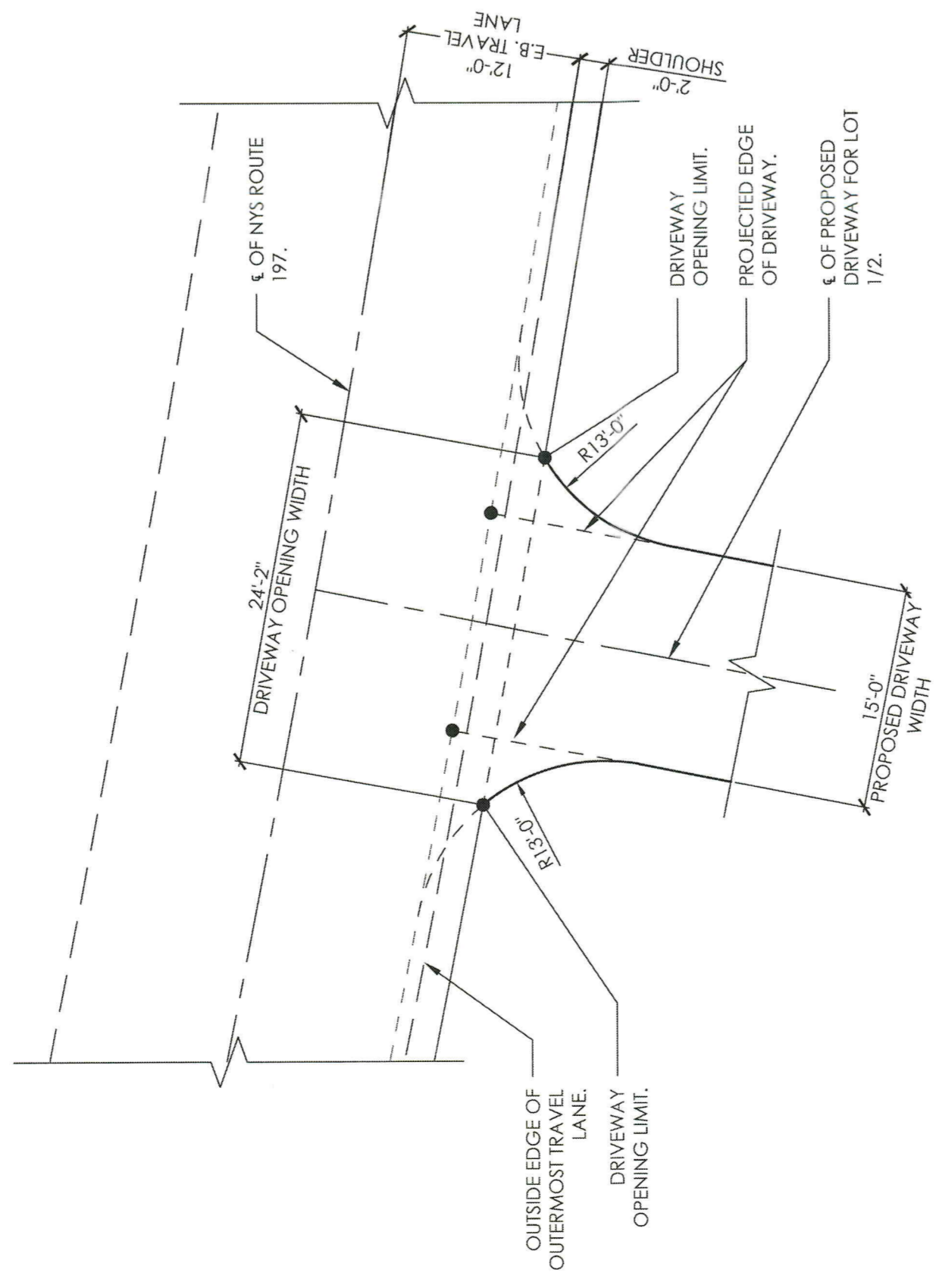

LOT 1/2 DRIVEWAY LAYOUT DETAIL
1" = 10'-0"

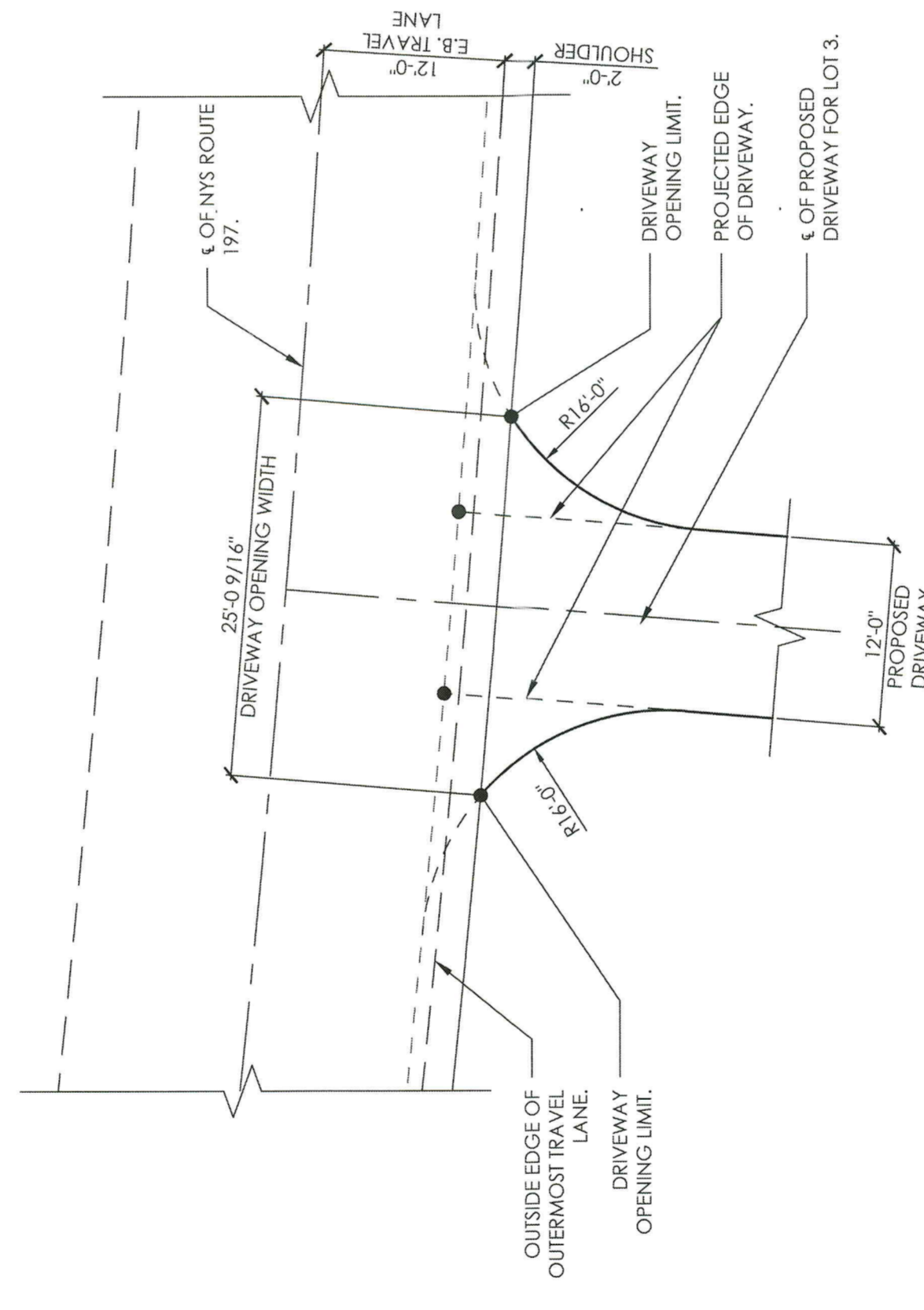

LOT 3 DRIVEWAY LAYOUT DETAIL
1" = 10'-0"

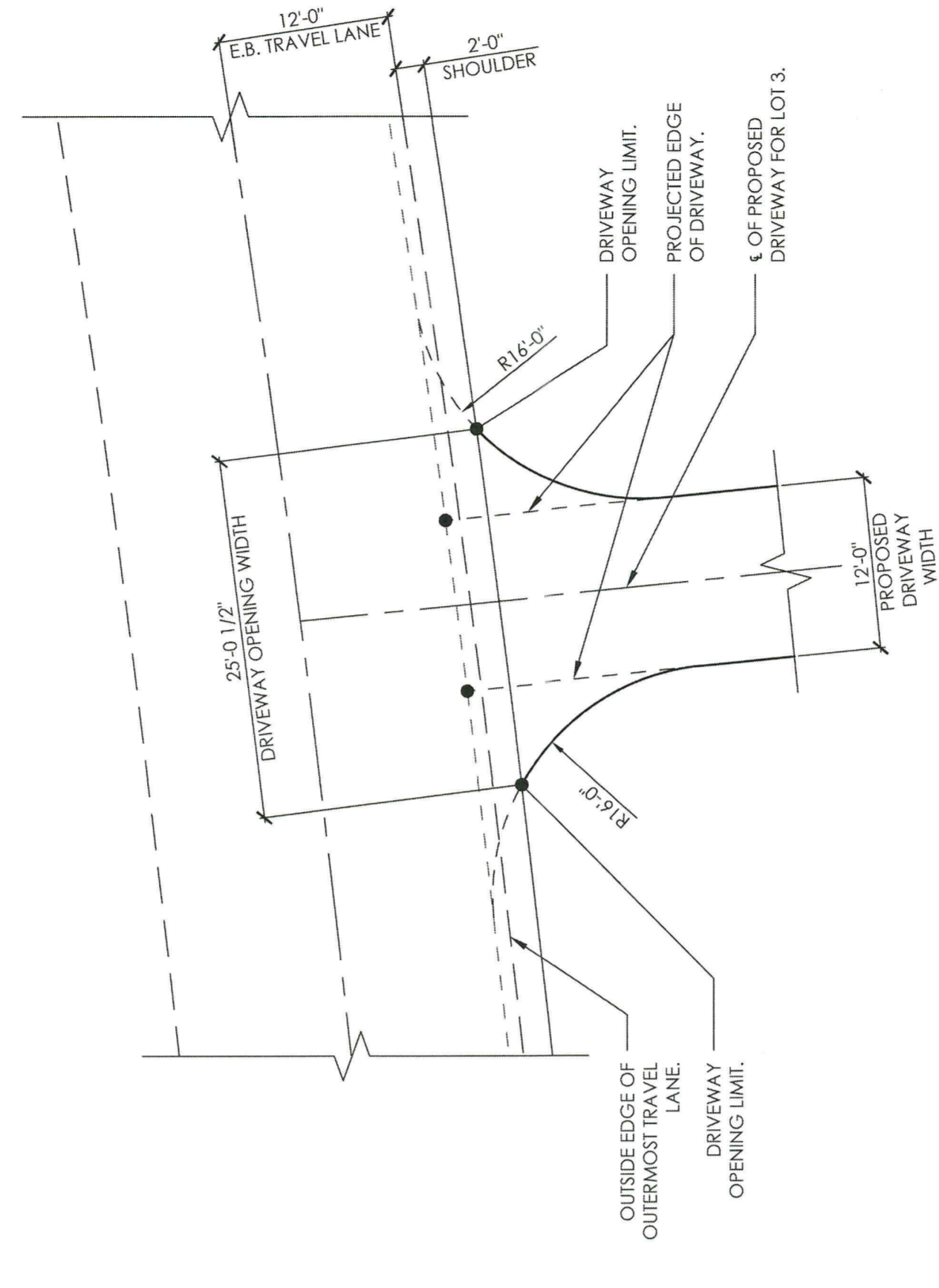

LOT 4 DRIVEWAY LAYOUT DETAIL
1" = 10'-0"

Notes:

IT IS A VIOLATION OF NEW YORK STATE EDUCATION LAW FOR ANY PERSON, UNLESS THEY ARE ACTING UNDER THE DIRECTION OF A LICENSED PROFESSIONAL ENGINEER, ARCHITECT, LANDSCAPE ARCHITECT, OR LAND SURVEYOR, TO PREPARE, SEAL, SIGN, OR ALTER ANY DRAWING, SPECIFICATION, OR REPORT BEARING THE STAMP OF A LICENSED PROFESSIONAL ENGINEER, ARCHITECT, LANDSCAPE ARCHITECT, OR LAND SURVEYOR, UNLESS THE ALTERNING LICENSED PROFESSIONAL SHALL STAMP THE DOCUMENT AND INCLUDE THE NOTATION "ALTERED BY FOLLOWED BY THEIR SIGNATURE, THE DATE OF SUCH ALTERATION, AND SPECIFIC DESCRIPTION OF THE ALTERATION."

REV: DESCRIPTION: **FOR REVIEW**
STATUS: BY: DATE:

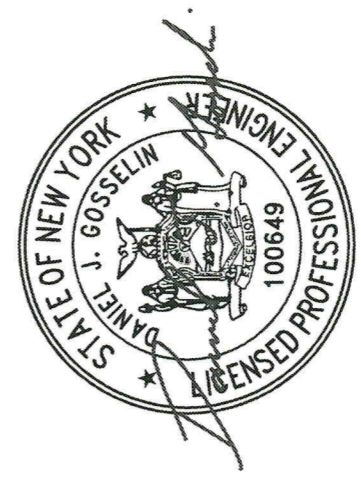

Daniel J. Gosselin, PE
PO BOX 405
Gansevoort, NY 12831
(518) 744-0047
gosselin.daniel@live.com

CLIENT: **JIM & SUZANNE HOOPER**
46 Reynolds Road
Moreau, Saratoga County, NY 12828

SITE: **Cluster Subdivision**
Tax Map ID: 64-2-106.1
Moreau, NY

TITLE: **PROPOSED GENERAL DRAINAGE DETAILS**

SCALE: AS SHOWN
DATE: 11/30/2024
DRAWN: DJG
CHECKED: SFG
PROJECT NO: 24.262
REVISION: S-103

SUBSURFACE EVALUATION LOG

- TEST PIT PT-1
 0' TO 6"
 6" TO 24"
 24" TO 54"
- TOPSOIL
 BROWN SANDY LOAM WITH GRAVEL
 GRAYISH BROWN SILT WITH SAND
- NOTING WAS ENCOUNTERED AT 42"
 NO GROUNDWATER WAS ENCOUNTERED.
 NO BEDROCK ENCOUNTERED.
 ROOTS TO 6"
- PERC. TEST PT-1
 STABILIZED PERCOLATION RATE OF 5 MIN. 41 SEC./IN.
 TEST AT ±18" BELOW EXIST GRADE.
- PERC. TEST PT-2
 STABILIZED PERCOLATION RATE OF 5 MIN. 10 SEC./IN.
 TEST AT ±18" BELOW EXIST GRADE.
- TEST PIT NO. 1 WAS WITNESSED AND EVALUATED BY DANIEL J. GOSSELIN, P.E. ON AUGUST 25, 2022.
 PERCOLATION TEST PT-1 & PT-2 WERE COMPLETED BY DANIEL J. GOSSELIN, P.E. ON AUGUST 25, 2022.

SUBSURFACE WASTEWATER TREATMENT DESIGN TABLE

# OF BEDROOMS	DESIGN FLOW RATE (GAL/DAY)	MIN. SEPTIC TANK CAPACITY (GAL)	MIN. ABSORPTION AREA (SF)	MIN. TRENCH LENGTH (FT)
2	220	1,000	440	220
3	330	1,000	660	330
4	440	1,250	880	440
5	550	1,500	1,100	550
6	660	1,750	1,320	660

TYPICAL WASTEWATER ABSORPTION TRENCH DETAIL

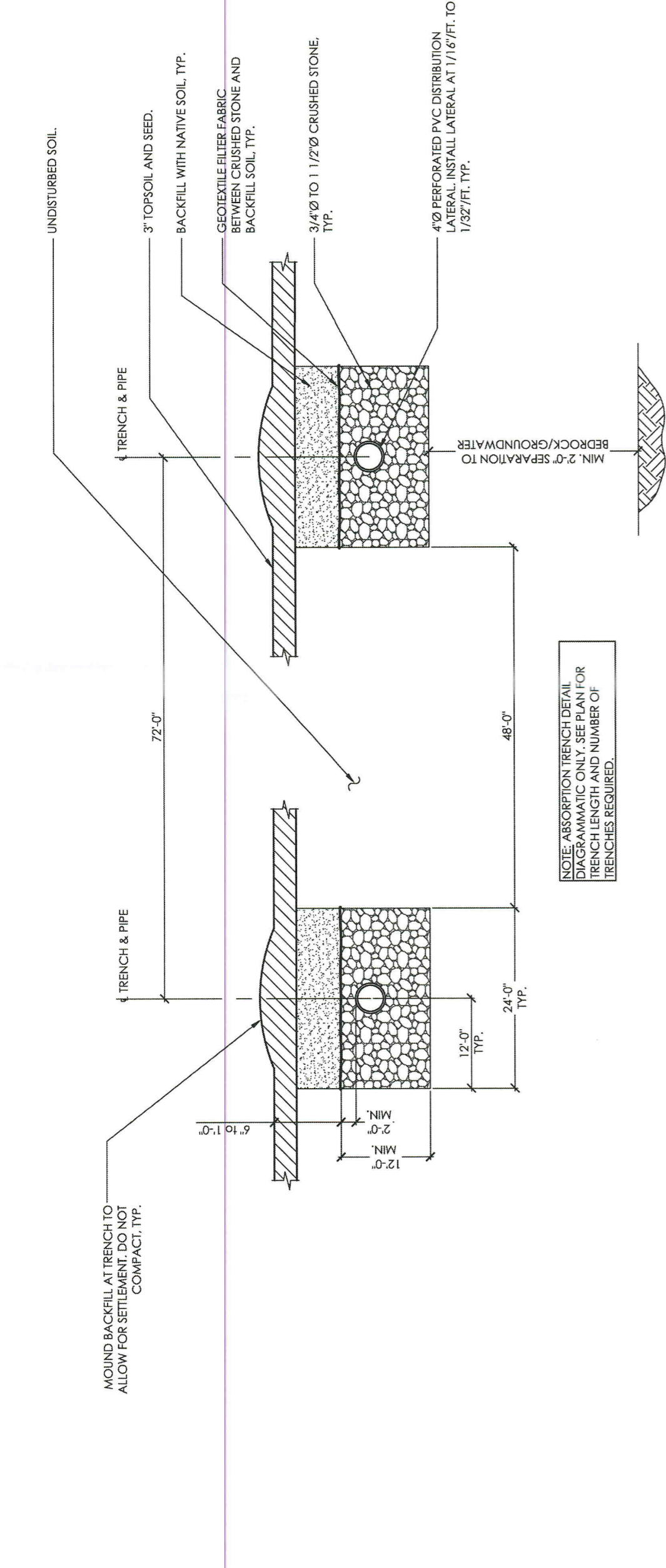

SCALE: ABSORPTION TRENCH DETAIL OR TRENCH LENGTH AND NUMBER OF TRENCHES REQUIRED.

SEPTIC TANK DETAIL

N.T.S.

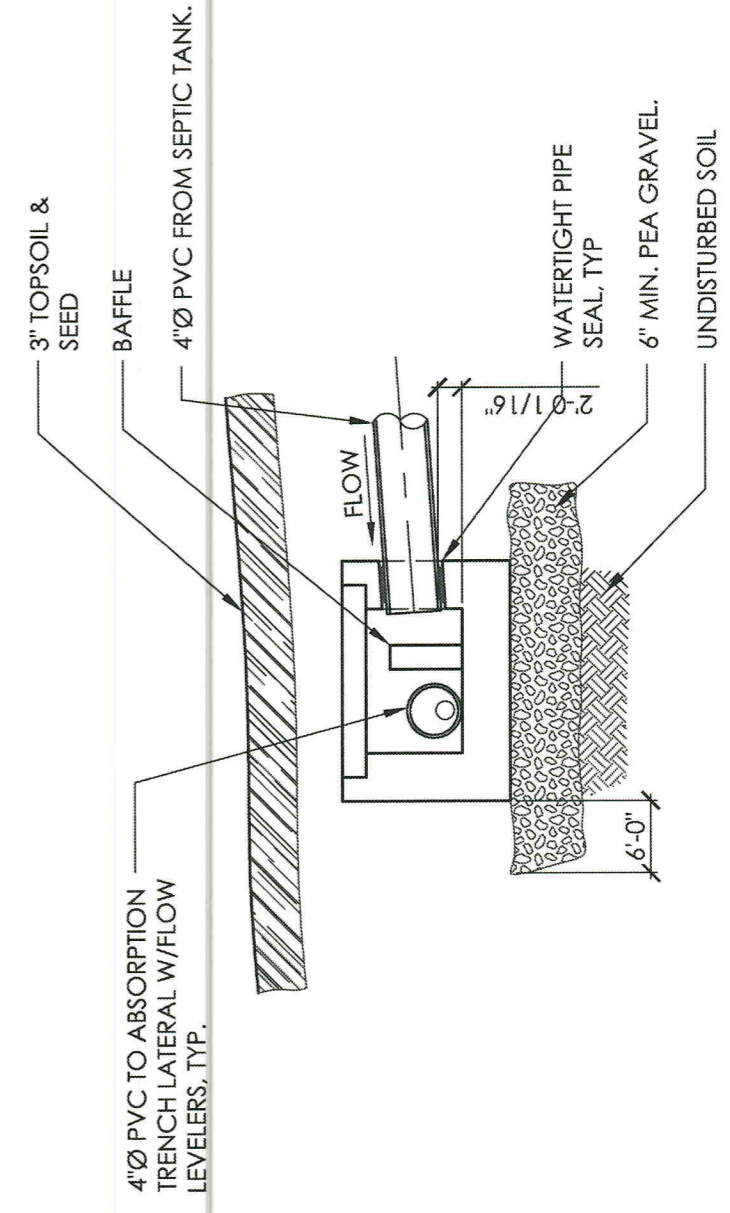
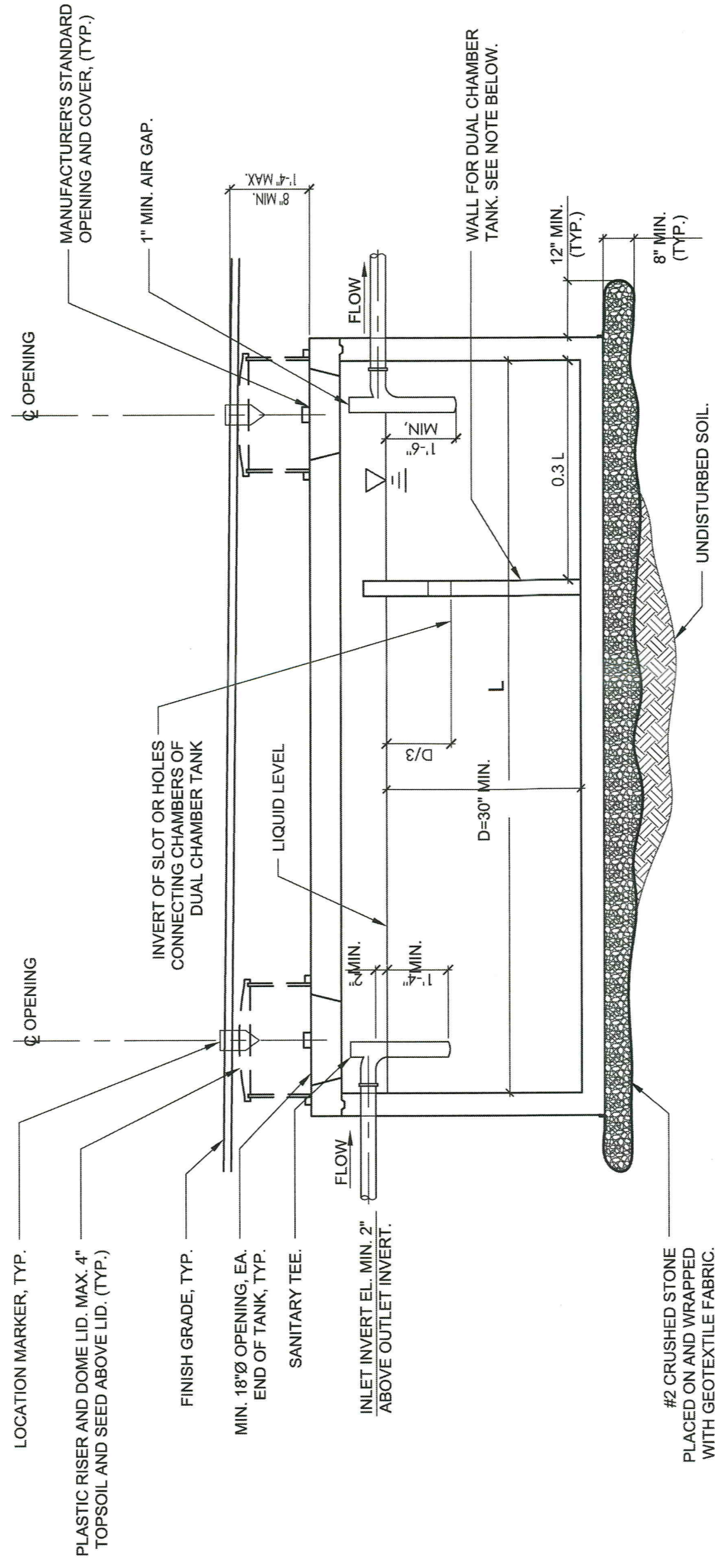

WASTEWATER TREATMENT SYSTEM NOTES

- THE ON-SITE SUBSURFACE WASTEWATER TREATMENT SYSTEM SHALL BE AN ABSORPTION TRENCH SYSTEM. THE BASIS OF DESIGN FOR THE SYSTEM IS AS FOLLOWS:
 NUMBER OF BEDROOMS SEE TABLE
 DESIGN WASTEWATER FLOW RATE SEE TABLE
 DESIGN PERCOLATION RATE 3-4.5 min/in
 SEPTIC TANK MIN. CAPACITY SEE TABLE
 SEPTIC TANK CAPACITY PROVIDED SEE TABLE
 DESIGN APPLICATION RATE 0.50 gal/cap/day
 REQUIRED ABSORPTION AREA = (DESIGN RATE GAL/DAY)/(0.50 GAL/DAY/DFP SQ. FT.) = SEE TABLE
 REQUIRED ABSORPTION TRENCH LENGTH = AREA SQ. FT./2 FT. TRENCH WIDTH = SEE TABLE
 PLUMBING FIXTURES MAX. 1.6 Gal./Flush WATER CLOSETS SEE TABLE
- ALL WASTEWATER TREATMENT SYSTEM COMPONENTS SHALL BE IN STRICT ACCORDANCE WITH THE SYSTEM DESIGNATION INDICATED ON THESE DRAWINGS. WITH ALL N.T.S. DEPT. OF HEALTH AND WASHINGTON COUNTY REQUIREMENTS.
- THE DISCHARGE OF WASTE FROM SPA TUBS, SUMP PUMPS, ROOF DRAINS, WATER TREATMENT SYSTEM BACKWASH AND NON-CONSERVING WATER FIXTURES IS PROHIBITED.
- GRAVITY SEWER PIPING AT THE ABSORPTION FIELD LOCATION SHALL BE SDR 26 PVC PIPE WITH SOLVENT WELDED JOINTS AND FITTINGS. GRAVITY SEWER PIPING FROM THE SEPTIC TANK TO THE DISTRIBUTION BOX SHALL BE SCH. 40 PVC PIPE WITH SOLVENT WELDED JOINTS AND FITTINGS. INSTALL SEWER PIPING ON MIN. 6" LAYER OF CRUSHED STONE AT A UNIFORM SLOPE WITH NO SAGS OR HUMPS; THE MINIMUM SLOPE FOR ALL GRAVITY SEWER PIPING SHALL BE 1/4" FT. (2%).
- NO HEAVY EQUIPMENT OR VEHICULAR TRAFFIC SHALL BE ALLOWED WITHIN THE LIMITS OF THE ABSORPTION FIELD AFTER FILL MATERIAL HAS BEEN PLACED BOTH DURING OR AFTER CONSTRUCTION.
- PLACEMENT OF BACKFILL, CRUSHED STONE TRENCHES, PERFORATED PIPE AND FILTER FABRIC SHALL BE AS SHOWN.
- CRUSHED STONE USED FOR THE ABSORPTION TRENCHES SHALL BE WASHED STONE 3/4" TO 1 1/2" IN SIZE. HOLD BOTTOM OF THE TRENCHES LEVEL.
- DISTRIBUTION BOX LATERALS SHALL BE PERFORATED 4" Ø SDR 35 PVC PIPE. INSTALL LATERALS AT 1/16" FT. TO 1/32" FT. SLOPE AWAY FROM THE DISTRIBUTION BOX WITH HOLES DOWNWARD. PROVIDE END CAPS AT ALL LATERALS.
- TOPSOIL AND SEED THE ACTIVE ABSORPTION FIELD AREA AND ALL OTHER DISTURBED AREAS IMMEDIATELY AFTER CONSTRUCTION.
- ALL PLUMBING WORK SHALL BE COMPLETED IN STRICT ACCORDANCE WITH ALL REQUIREMENTS OF THE BUILDING CODE OF NEW YORK STATE.
- SUBMITTALS, THE CONTRACTOR SHALL SUBMIT (MIN. 10) COPIES OF SHOP DRAWINGS AND SUBMITTALS FOR THE FOLLOWING ITEMS FOR REVIEW BY THE ENGINEER (N.Y.S. DEPT. OF HEALTH AND WASHINGTON COUNTY):
 - UPON INSTALLATION OF THE SEPTIC TANK AND DISTRIBUTION PIPING.
 - UPON EXCAVATION OF THE ABSORPTION TRENCHES, PRIOR TO THE INSTALLATION OF THE DISPOSAL LATERALS
 - UPON COMPLETION OF ABSORPTION TRENCH INSTALLATION, PRIOR TO BACKFILLING THE SYSTEM.
- UPON COMPLETION OF CONSTRUCTION, THE CONTRACTOR SHALL PREPARE A MAP OF AS-BUILT CONDITIONS INDICATING A MINIMUM OF TWO TIE DIMENSIONS FROM ADJACENT CORNERS OF THE RESIDENCE TO THE SEPTIC TANK INLET AND OUTLET COVERS, THE DISTRIBUTION BOX AND EACH CORNER OF THE LEACH FIELD.

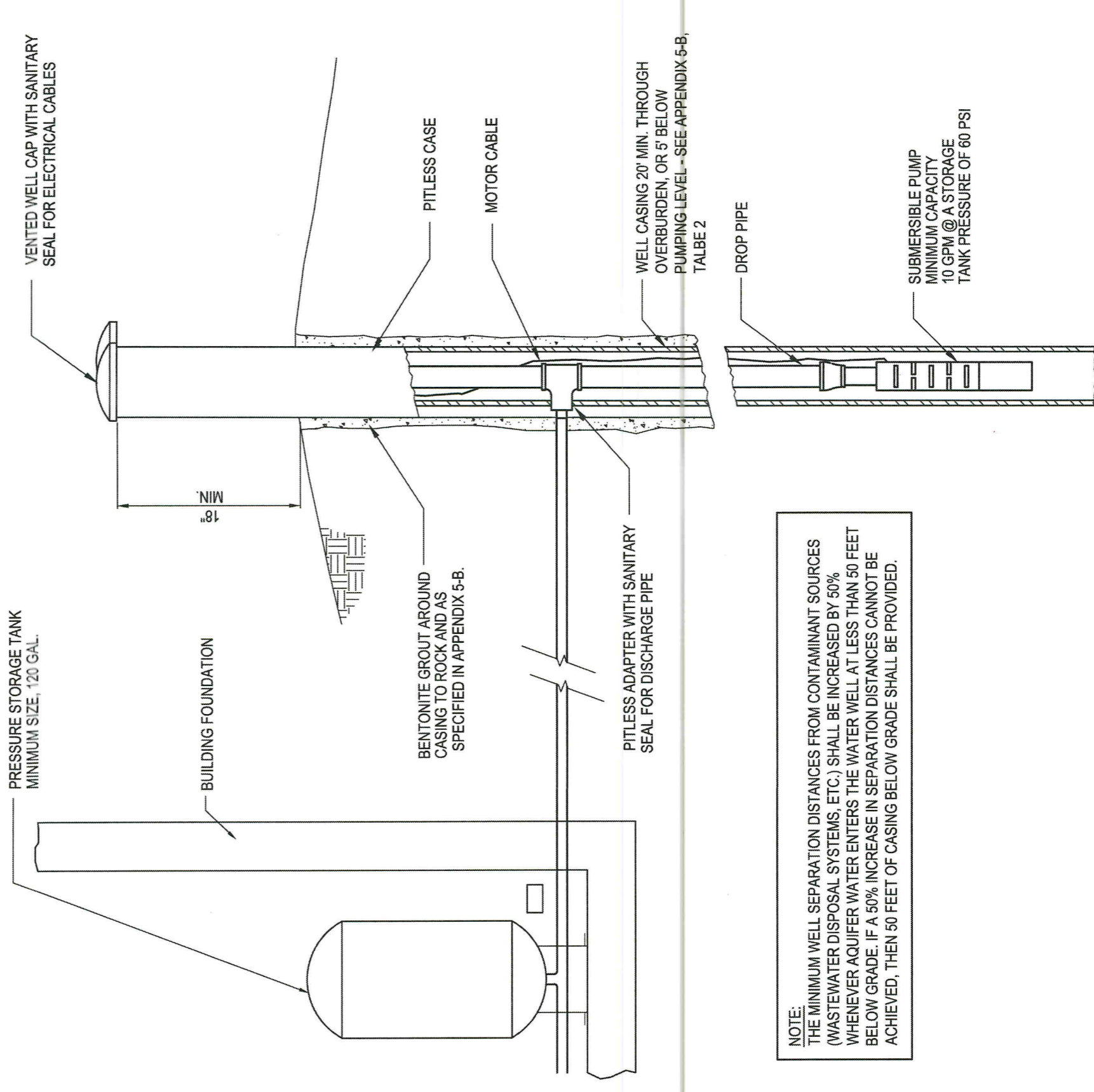

TYPICAL WELL DETAIL

NOT TO SCALE

ALL WELLS ARE TO BE CONSTRUCTED AND TESTED IN ACCORDANCE WITH NYS SANITARY CODE PART 5, SUBPART 5-1, APPENDIX 5-B.

REV. DESCRIPTION: BY: DATE:

STATUS: FOR REVIEW



Daniel J. Gosselin, PE
 PO BOX 405
 Carle Place, NY 11731
 (516) 744-0047
 gosselin.daniel@live.com

CLIENT: JIM & SUZANNE HOOPER
 46 Reynolds Road
 Moreau, Saratoga County, NY 12828

SITE: Cluster Subdivision
 Tax Map ID: 64-2-106.1
 Moreau, NY

TITLE: PROPOSED GENERAL SEPTIC DETAILS & NOTES

SCALE: AS SHOWN
 DATE: 11/30/2024
 DRAWN: DJG
 CHECKED: SFG

PROJECT NO: DRAWING NO: S-105
 REVISION:

Notes:

IT IS A VIOLATION OF NEW YORK STATE EDUCATION LAW FOR ANY PERSON, UNLESS THEY ARE ACTING UNDER THE AUTHORITY OF A LICENSED PROFESSIONAL ARCHITECT, ARCHITECT, LANDSCAPE ARCHITECT, OR LAND SURVEYOR, TO ALTER ANY ITEM IN ANY WAY, IF AN ITEM BEARING THE STAMP OF A LICENSED PROFESSIONAL IS ALTERED, THE ALTERING LICENSED PROFESSIONAL SHALL BE RESPONSIBLE FOR THE ALTERATION. THE NOTATION ALTERED BY FOLLOWED BY THEIR SIGNATURE, THE DATE OF ALTERATION, AND A SPECIFIC DESCRIPTION OF THE ALTERATION.

Notes:
 IT IS A VIOLATION OF NEW YORK STATE EDUCATION LAW FOR ANY PERSON, UNLESS THEY ARE ACTING UNDER THE AUTHORITY OF A LICENSED PROFESSIONAL ENGINEER, ARCHITECT, SURVEYOR, LANDSCAPE ARCHITECT, OR SURVEYOR, TO ALTER ANY ITEM IN ANY WAY IF AN ITEM BEARING THE STAMP OF A LICENSED PROFESSIONAL IS ALTERED. THE DOCUMENT AND INCLUDE THE NOTATION "ALTERED BY FOLLOWED BY THEIR SIGNATURE, THE DATE OF ALTERATION, AND SPECIFIC DESCRIPTION OF THE ALTERATION."

SEEDING AND MULCHING NOTES

- RESTORE ALL SURFACES TO AS GOOD AS OR BETTER CONDITION THAN BEFORE CONSTRUCTION AS SOON AS POSSIBLE FOLLOWING COMPLETION OF WORK IN ANY AREA.
- UNDER NO CONDITION SHALL ANY AREA OF UNPROTECTED EXCAVATION, BORROW, OR FILL BE LEFT IN AN UNPROTECTED CONDITION. ANY PORTION OF AN AREA ON WHICH CLEARING AND GRUBBING, EXCAVATION, BORROW, OR FILL HAD PERMANENTLY CEASED SHALL BE STABILIZED, BY EITHER TEMPORARY OR PERMANENT MEANS. THE CONTRACTOR WILL ALSO BE AWARE OF IMPENDING WEATHER CONDITIONS AND THE NEED TO APPLY RECIP MULCH ON AREAS THAT WORK IS PROGRESSING.
- IN AREAS WHERE SOIL DISTURBANCE ACTIVITY HAS TEMPORARILY OR PERMANENTLY CEASED, THE APPLICATION OF SOIL STABILIZATION MEASURES MUST BE INITIATED BY THE END OF THE NEXT BUSINESS DAY AND COMPLETED WITHIN FOURTEEN (14) DAYS FROM THE DATE THE CURRENT SOIL DISTURBANCE ACTIVITY CEASED.
- MAINTENANCE OF TEMPORARY SEEDED AREAS SHALL INCLUDE RE-SEEDING AS NEEDED (OR A.O.B.E.) TO ESTABLISH A SATISFACTORY STAND OF TURF. THE COST OF RESEEDING SHALL BE AT THE CONTRACTOR'S EXPENSE. IT IS HIGHLY RECOMMENDED THAT THE SEEDING BE DONE PRIOR TO INSTALLING THE RECIP.
- ALL SLOPES SHALL BE BROUGHT TO FINISHED GRADE AND TRIMMED AS SOON AS POSSIBLE.
- PERMANENT EROSION CONTROL MEASURES OF SEEDING AND MULCHING USED ONLY WITHIN SEEDING DATES SHALL BE CARRIED OUT TO THE END OF THE NEXT BUSINESS DAY. ALL TEMPORARY EROSION AND SEDIMENT CONTROL MEASURES AS SHOWN IN THE TEMPORARY SLOPE TREATMENT TABLE SHALL BE EMPLOYED AS INDICATED.
- ALL DISTURBED AREAS WILL BE PERMANENTLY STABILIZED IN ACCORDANCE WITH THE NYS DECORATION AND MAINTENANCE REGULATIONS. FOR ALL UNPAVED DISTURBED AREAS, SPECIFICATIONS DIRECTED FOR TURF ESTABLISHMENT, PLACE 9" OF TOPSOIL AND SEED WITH AN APPROPRIATE PERENNIAL GRASS SEED MIX AND MULCH WITH STRAW. ALL SEED MIXES MUST COMPLY WITH THE NOTES BELOW AND BE PRE-APPROVED BY THE ENGINEER PRIOR TO SEEDING OPERATIONS. MULCH SHALL BE MAINTAINED UNTIL A SUITABLE COVER IS ESTABLISHED.

MIXTURES	RATE PER ACRE (LBS)
A. PERENNIAL RYEGRASS	30
TALL FESCUE OR SMOOTH BROMGRASS	20
REDTOP	25
KENTUCKY BLUEGRASS	25
CREeping RED FESCUE	20
PERENNIAL RYEGRASS	10

FINAL SITE STABILIZATION WILL BE DEFINED AS 80% VEGETATIVE COVER OVER THE ENTIRE SITE. LAWN AREAS SHALL BE CONSIDERED STABILIZED WHEN THE VEGETATION HAS REACHED A DENSITY THAT MEETS ALL TEMPORARY EROSION AND SEDIMENT CONTROL PRACTICES WILL BE REMOVED SUBJECT TO THE APPROVAL OF THE ENGINEER.

INSPECTION NOTES

- THE CONTRACTOR SHALL INSPECT ALL EROSION AND SEDIMENT CONTROL MEASURES ON A WEEKLY BASIS OR A O.B.E. REPAIRS SHALL BE MADE BY THE CONTRACTOR AS NEEDED WITHIN 3 CALENDAR DAYS, AND SEDIMENT SHALL BE REMOVED BY THE CONTRACTOR WHEN THE STORAGE VOLUME OF AN EROSION CONTROL MEASURE IS APPROACHING ONE-HALF OF ITS INTENDED CAPACITY OR A.O.B.E. FAILURE TO COMPLY WITH THIS PROVISION IS BASIS TO SHUT DOWN THE PROJECT, AT NO EXPENSE TO THE ENGINEER OR OWNER.
- IF SOIL DISTURBANCE ACTIVITIES HAVE BEEN TEMPORARILY SUSPENDED AND TEMPORARY STABILIZATION MEASURES HAVE BEEN APPLIED TO ALL DISTURBED AREAS, THE CONTRACTOR CAN STOP CONDUCTING THE MAINTENANCE INSPECTIONS. THE CONTRACTOR SHALL BEGIN CONDUCTING THE MAINTENANCE INSPECTIONS AS SOON AS SOIL DISTURBANCE ACTIVITIES RESUME.

EROSION AND SEDIMENT CONTROL NOTES

- ALL EROSION AND SEDIMENT CONTROL MEASURES SHALL BE IMPLEMENTED AND MAINTAINED IN CONFORMANCE WITH THE MOST CURRENT EDITION OF THE NEW YORK STATE STANDARDS AND SPECIFICATIONS FOR EROSION AND SEDIMENT CONTROL. THE BOOKS ARE AVAILABLE FOR PURCHASE AT THE NYS DEPARTMENT OF ENVIRONMENTAL CONSERVATION. ADDITIONAL PROVIDE FOR EFFECTIVE EROSION CONTROL. ADDITIONAL STABILIZATION, EROSION AND SEDIMENT CONTROL MEASURES SHALL BE IMPLEMENTED TO CONTROL OR TREAT THE SEDIMENT SOURCE. THIS SHALL BE THE RESPONSIBILITY OF THE CONTRACTOR.
- ANY PROPOSED CHANGES TO THE EROSION AND WATER POLLUTION CONTROL MEASURES SHALL BE APPROVED BY THE ENGINEER PRIOR TO BEING IMPLEMENTED.
- THE SYMBOLS SHOWN ON THE CONSTRUCTION PLAN SHEETS REPRESENT THE EROSION CONTROL ITEMS TO BE USED IN THE CONSTRUCTION OF THE EROSION CONTROL MEASURES. THE METHOD INCLUDING APPLICABLE PERMITS AND CERTIFICATES SHALL BE SHOWN ON THE PLANS AND DETAILS IN THE CONTRACT DOCUMENTS.
- THE CONTRACTOR IS ADVISED THAT THE LOCATIONS OF THE TEMPORARY DEVICES ARE APPROXIMATE. THE EXACT DEVICE LOCATIONS TO ACCOMMODATE THE PROPOSED WORK SHALL BE THE CONTRACTOR'S RESPONSIBILITY.
- THE CONTRACTOR SHALL COMPLY WITH ALL PROVISIONS OF THE DEPARTMENT OF ENVIRONMENTAL CONSERVATION SECTION 401 BLANKET WATER QUALITY CERTIFICATION PERMIT AS APPLICABLE.
- THE CONTRACTOR'S ATTENTION IS DIRECTED TO THE FACT THAT THROUGHOUT THE DURATION OF THE CONTRACT, IT WILL BE THE CONTRACTOR'S RESPONSIBILITY TO PROTECT ALL WATER COURSES FROM SEDIMENT OR POLLUTANTS ORIGINATING FROM ANY WORK BEING DONE ON OR IN SUPPORT OF THIS PROJECT.
- THE POLLUTION CONTROL NOTES AND DETAILS SHOWN IN THESE DRAWINGS ARE NOT INTENDED TO BE ALL INCLUSIVE BUT TO SERVE AS A GUIDELINE FOR THE DEVELOPMENT OF THE CONTRACTOR'S REQUIRED EROSION CONTROL SCHEME.
- CARE SHALL BE TAKEN TO RETAIN VEGETATION AND PREVENT DAMAGE TO TREES & ORNAMENTAL PLANT MATERIAL WITHIN AND ADJACENT TO THE PROJECT. ANY DAMAGE CAUSED TO THIS VEGETATION SHALL BE RESTORED AT THE EXPENSE OF THE CONTRACTOR AS DIRECTED BY THE ENGINEER.

TEMPORARY EROSION AND SEDIMENT CONTROL NOTES

- THE PROPOSED WORK WILL REQUIRE THAT THE TEMPORARY EROSION AND SEDIMENT CONTROLS BE PLACED OVER THE COURSE OF THE PROJECT AS WORK PROGRESSES. NO WORK SHALL BE PERFORMED WITHOUT THE APPROPRIATE CONTROLS ON-SITE.
- ALL EROSION AND SEDIMENT CONTROLS SHALL BE PLACED PRIOR TO STARTING ANY OTHER WORK. STAPLES SHALL BE PLACED IN PLACE UNTIL THE NEW SLOPES ARE STABILIZED WITH SEEDING AND/OR SLOPE PROTECTION, AND A.O.B.E. STABILIZATION WILL BE CONSIDERED AS 80% COVER, PER SQUARE FOOT, ACROSS THE SITE.
- SILT FENCE WILL NOT BE ALLOWED ON THIS PROJECT. BIO-FIBER ROLLS (MAY FIBER LOSS, SEDIMENT LOSS, WAFTLES) WILL BE USED IN LIEU OF SILT FENCE. SEE DETAIL SHEET EC-2.
- BIO-FIBER ROLLS ARE USED TO CAPTURE SEDIMENT DEPOSITS THAT BREAK FREE FROM THE EROSION CONTROLS.
- IMMEDIATELY UPON COMPLETION OF EXCAVATION OR OTHER TEMPORARY CONTROL MEASURES, BIO-FIBER ROLLS IN ALL ROADWAY AND OUTLET DITCHES A.O.B.E. OR AS SHOWN TO PREVENT SEDIMENTATION.
- ROLLED EROSION CONTROL PRODUCT (RECIP) IS FOR EROSION PREVENTION.
- STREETS/DRIVEWAYS SHALL BE CLEANED DAILY IN A MANNER WHICH WILL MINIMIZE DUST.
- THE CONTRACTOR SHALL FURNISH AND APPLY WATER FOR DUST CONTROL AS NEEDED.
- CONTRACTOR SHALL PROTECT ALL STOCKPILED SOILS WITH APPROPRIATE EROSION AND SEDIMENT CONTROL MEASURES, FILTER FABRIC.
- THERE ARE NO LOCATIONS WITHIN THE PROJECT LIMITS FOR THE DISPOSAL OF CONSTRUCTION DEBRIS OR SPOILS.

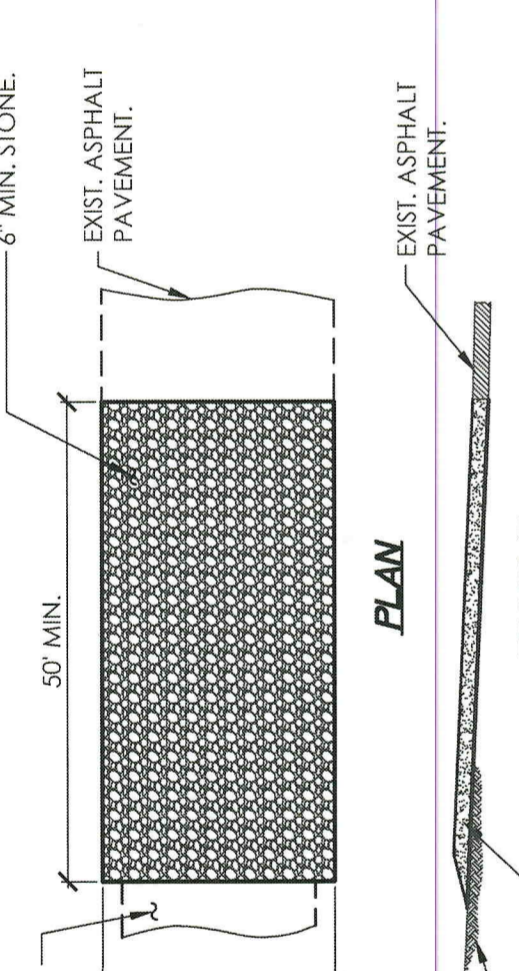

- STABILIZED CONSTRUCTION ENTRANCE NOTES:**
- STONE SHALL CONFORM WITH NYS DOT SPEC. SECTION 703-02 SIZE DESIGNATION 3.
 - GEOTEXTILE FABRIC SHALL BE MIRAFIX 600X OR EQUIVALENT.
 - PERIODICALLY TOP-DRESS ENTRANCE WITH NEW STONE AS SEDIMENT ACCUMULATES. ALL SEDIMENT DROPPED OR WASHED ONTO THE PUBLIC RIGHT-OF-WAY SHALL BE REMOVED IMMEDIATELY.

STABILIZED CONSTRUCTION ENTRANCE

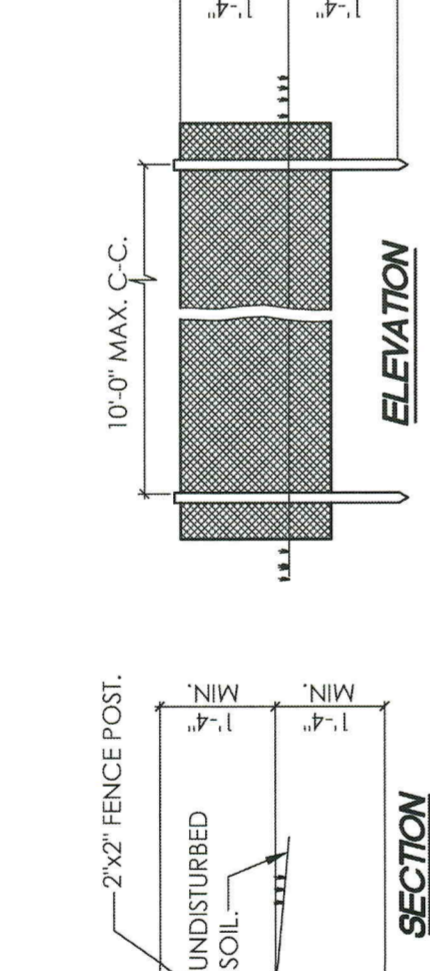

- SILT FENCE NOTES:**
- FILTER CLOTH TO BE FASTENED SECURELY TO POSTS WITH STAPLES OR TIES AT 6" MAX. SPACINGS.
 - WHEN TWO SECTIONS OF FILTER CLOTH ADJOIN EACH OTHER THEY SHALL BE OVERLAPPED BY 6" AND FOLDED.
 - MAINTENANCE SHALL BE PERFORMED AS NEEDED AND MATERIAL REMOVED WHEN 'BULGES' DEVELOP IN THE SILT FENCE.

SILT FENCE DETAIL

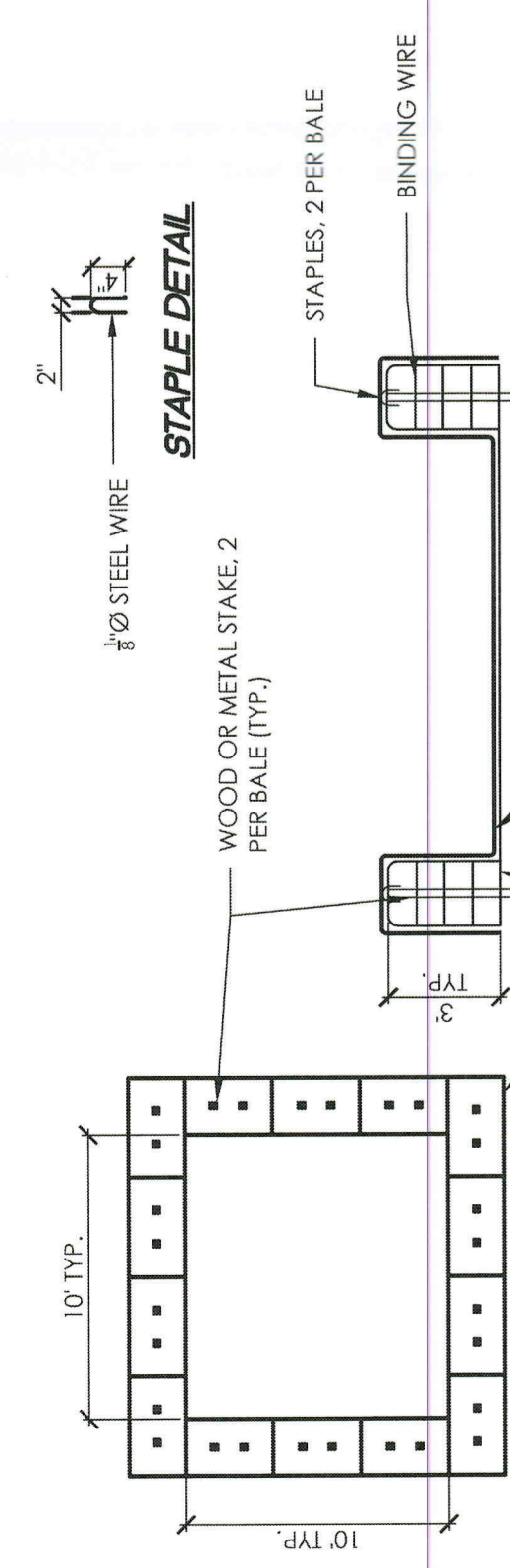
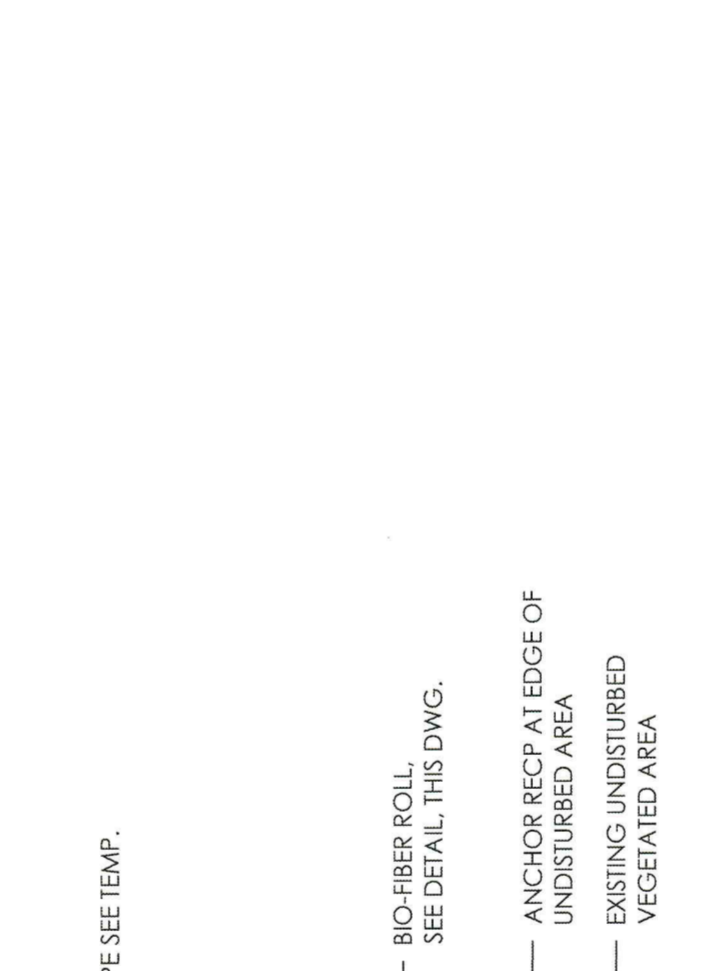

- CONCRETE TRUCK WASHOUT NOTES:**
- LOCATE WASHOUT STRUCTURE A MINIMUM OF 100 FEET AWAY FROM OPEN CHANNELS, STORM DRAIN INLETS, SENSITIVE AREAS, WETLANDS, BUFFERS AND WATER COURSES AND AWAY FROM CONSTRUCTION TRAFFIC, OR AS SHOWN ON THE PLANS.
 - SIZE WASHOUT STRUCTURE FOR VOLUME NECESSARY TO CONTAIN WASH WATER AND SOLIDS AND MAINTAIN AT LEAST 4 INCHES OF FREEBOARD. TYPICAL DIMENSIONS ARE 10' x 10' x 3' DEEP. WASHOUT MAY BE TWO STAKED BALES OR PARTIALLY EXCAVATED TO REACH 3' DEPTH.
 - PREPARE SOIL BASE FREE OF ROCKS OR OTHER DEBRIS THAT MAY CAUSE TEARS OR HOLES IN THE GEOMEMBRANE FOR GEOMEMBRANE USE 10 MIL OR THICKER UV RESISTANT IMPERMEABLE SHEETING, FREE OF HOLES AND TEARS OR OTHER DEFECTS THAT COMPROMISE IMPERMEABILITY OF THE MATERIAL.
 - PROVIDE A SIGN FOR THE WASHOUT IN CLOSE PROXIMITY TO THE FACILITY.
 - INSPECT WASHOUT DAILY. KEEP PRACTICE WATER TIGHT. REPLACE IMPERMEABLE LINER IF DAMAGED (E.G., RIPPED OR PUNCTURED). EMPTY OR REPLACE WASHOUT STRUCTURE THAT IS 75% PERCENT FULL AND DISPOSE OF ACCUMULATED MATERIAL PROPERLY. DO NOT REUSE PLASTIC LINER. WET-VACUUM STORED LIQUIDS THAT HAVE NOT EVAPORATED AND DISPOSE OF IN AN APPROVED MANNER. PRIOR TO FORECASTED RAINSTORMS, REMOVE LIQUIDS OR COVER STRUCTURE TO PREVENT OVERFLOWS. REMOVE HARDENED SOLIDS, WHOLE OR BROKEN UP, FOR DISPOSAL OR RECYCLING. MAINTAIN RUNOFF DIVERSION AROUND EXCAVATED WASHOUT STRUCTURE UNTIL STRUCTURE IS REMOVED.

CONCRETE WASHOUT DETAIL

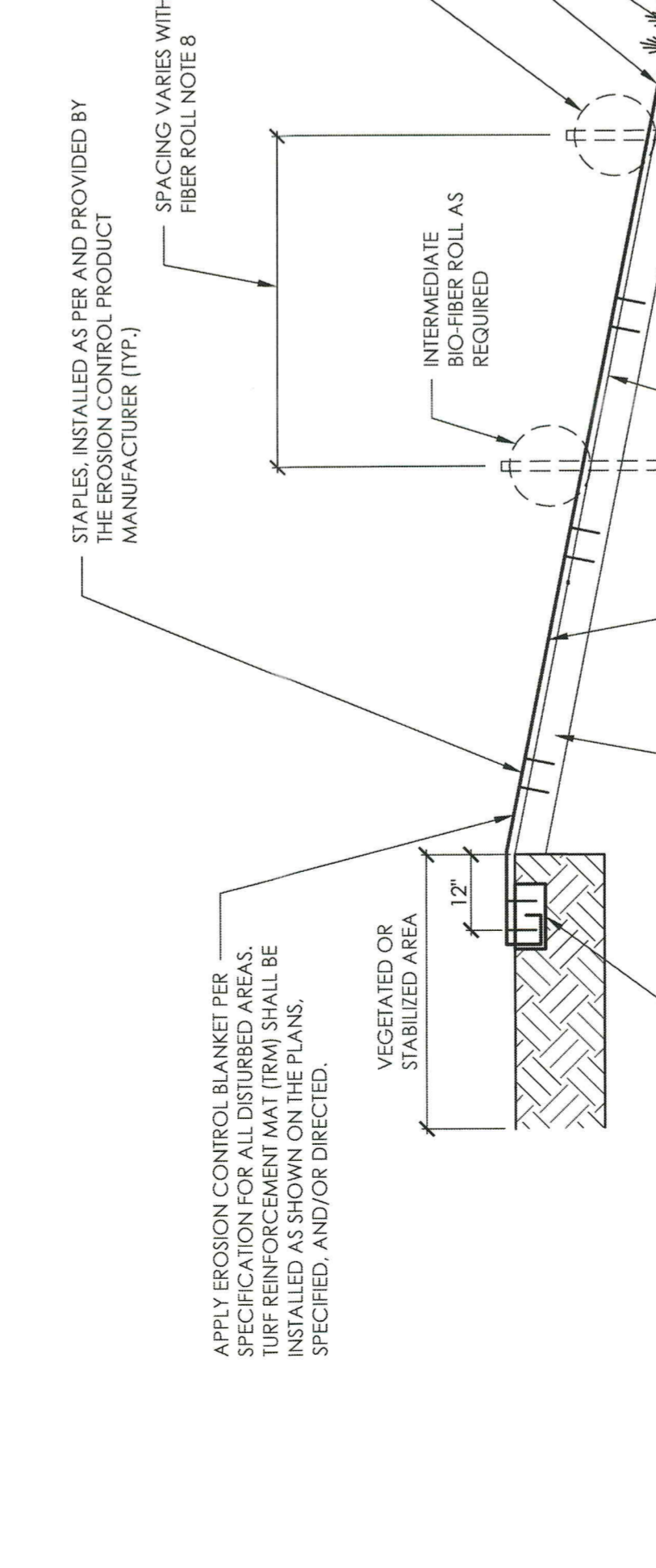
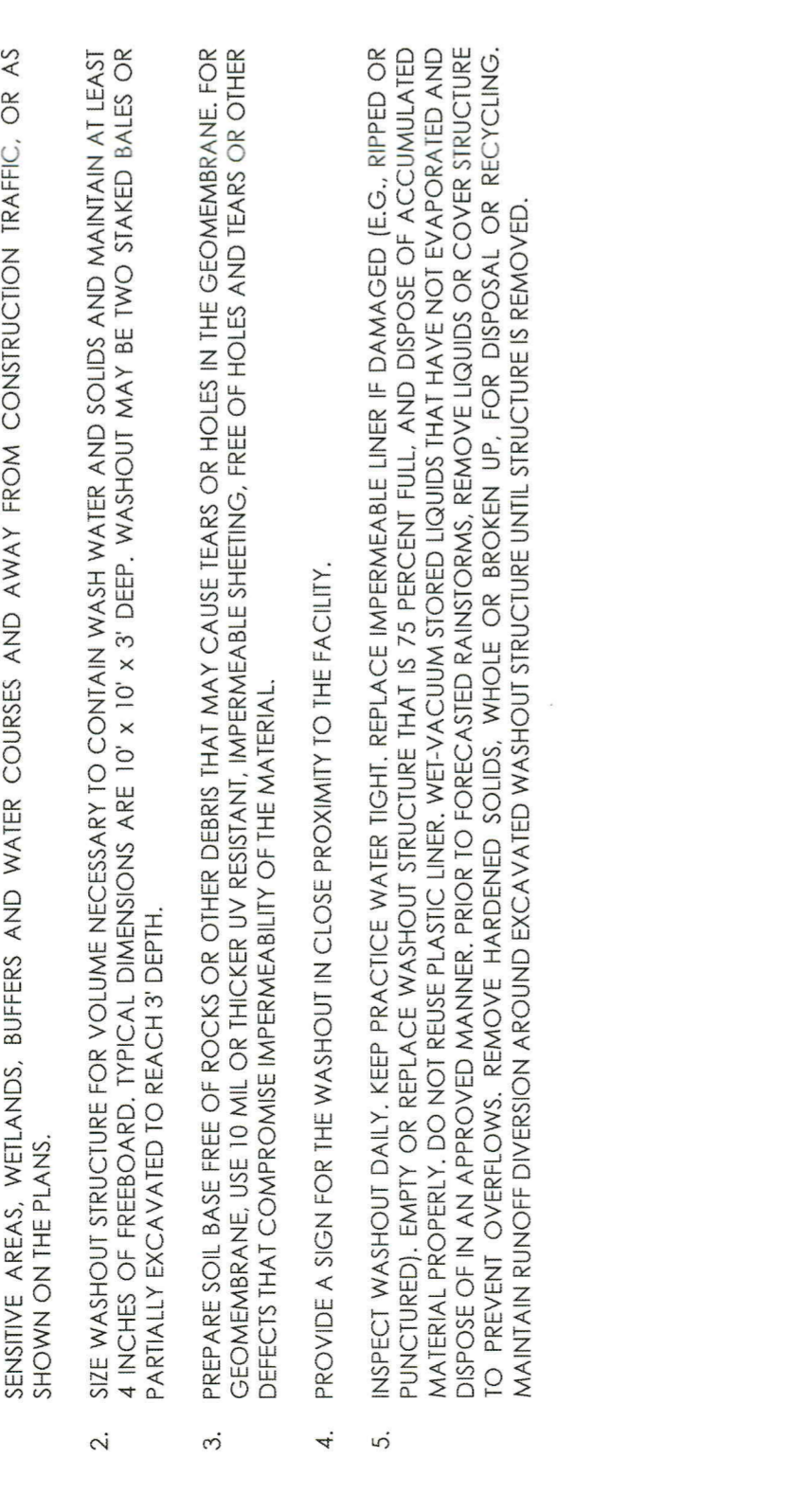

EROSION AND SEDIMENT CONTROL FOR ALL DISTURBED AREAS

- TEMPORARY & PERMANENT SLOPE STABILIZATION NOTES:**
- ITEMS IN THIS DETAIL MAY APPEAR EXAGGERATED TO SHOW DETAIL.
 - IF SLOPE IS BROUGHT TO FINISHED GRADE, PERMANENT TOP SOIL AND SEEDING SHALL BE INSTALLED PRIOR TO ROLLED EROSION CONTROL PRODUCT (RECIP). IF SLOPES ARE NOT BROUGHT TO FINISHED GRADE, THEY ARE TO BE TRACKED IN WITH A DOZER AND TREATED WITH TEMPORARY SEED & MULCH.
 - ROLLED EROSION CONTROL PRODUCT (RECIP) SHALL BE SELECTED FROM THE NYS DOT APPROVED MATERIALS LIST FOR CLASS 1 TYPE C RECIP AND HAVE A LONGEVITY OF AT LEAST TWELVE (12) MONTHS. PAYMENT WILL NOT BE MADE FOR MATERIALS THAT ARE NOT ON THE APPROVED LIST, IMPROPERLY INSTALLED, NOT MAINTAINED, DAMAGED BY THE CONTRACTOR AND/OR SUB-CONTRACTORS.
 - RECIP MUST BE FLUSH AND IN CONTACT WITH THE SOIL AND NOT RAISED BY CLUMPS, WEEDS, STICKS, ETC. AND MUST BE STAPLED SECURELY.
 - ALL RECIP DAMAGED BY CONTRACTOR AND/OR SUBCONTRACTORS SHALL BE REPAIRED WITHIN THREE (3) CALENDAR DAYS OF THE DAMAGE OCCURRENCE AT NO ADDITIONAL COST TO THE OWNER.
 - AS PART OF FINAL STABILIZATION, WOODEN STAKES TO BE REMOVED AND FIBER LOG MULCH NETTING CUT OPEN ALONG ENTIRE LENGTH.
 - THIS DETAIL IS INTENDED FOR ALL DISTURBED AREAS WITH FINAL GRADE GREATER THAN 6H:1V, BUT LESS THAN 2H:1V. FOR DISTURBED AREAS WITH FINAL GRADE GREATER THAN 2H:1V, SEE PERMANENT SLOPE STABILIZATION DETAIL.

Daniel J. Gosselin, PE
 PO BOX 405
 Catskill, NY 12831
 (518) 744-0047
 gosselin.daniel@live.com

JIM & SUZANNE HOOPER
 46 Reynolds Road
 Moreau, Saratoga County, NY 12828

SITE:	Cluster Subdivision Tax Map ID: 64-2-106.1 Moreau, NY
TITLE:	EROSION & SEDIMENT CONTROL DETAILS
SCALE:	AS SHOWN
PROJECT NO.:	24.262
DRAWING NO.:	S-103
CHECKED:	D.J.G.
DATE:	11/30/2024
DRAWN:	D.J.G.
SFG:	
REVISION:	



FOR REVIEW

REV: DESCRIPTION: BY: DATE: