

NOTES:

1. ALL CONNECTORS/CONNECTIONS THAT ARE CUT OR DISMANTLED SHOULD BE REMOVED AND DISPOSED OF OFF THE SITE AT AN APPROVED DISPOSAL SITE.
2. ALL SOLAR CELL "MODULES" CRACKED, FRACTURED, OR OTHERWISE UN-SUITABLE FOR SALVAGE AND RECYCLING, AS WELL AS ASSOCIATED SPILLED MATERIALS, SHOULD BE REMOVED AND DISPOSED OF OFF THE SITE AT AN APPROVED DISPOSAL SITE.
3. UPON THE FINAL REMOVAL OF ALL PHOTOVOLTAIC AND APPURTENANCES, ROAD AND STORMWATER MANAGEMENT COMPONENTS, THE LANDS WITHIN THE APPROVED LIMITS OF DISTURBANCE AS WELL AS THOSE THAT MAY HAVE BEEN IMPACTED BY OPERATIONS SHALL BE RESTORED BY USED OF THE TWO-PHASE PRACTICE OF DEEP RIPPING AND DECOMPACTION IN ACCORDANCE WITH THE DOCUMENT "DEEP-RIPPING AND DECOMPACTION" NYS DEC DIVISION OF WATER, APRIL 2008.
4. THIS PLAN SHOULD INCLUDE A "...SITE-SPECIFIC CHOICE OF AN APPROPRIATE VEGETATIVE GROUND-COVER SEED MIX, INCLUDING PROPER SEEDING RATIO OF ONE OR MORE PERENNIAL SPECIES WITH A DEEP TAPROOT SYSTEM AND THE PROPER AMOUNT OF LIME AND SOIL NUTRIENTS (FERTILIZER MIX) ADAPTED TO THE SOIL-NEEDS..." SEE SEED MIXTURE SCHEDULE AND SOIL AMENDMENT NOTE, THIS SHEET.
5. GRADE SLABS ARE NOTED TO BE REMOVED TO ONE FOOT BELOW GRADE, CRUSHED ON SITE AND RECYCLED EITHER ON SITE OR OFF. SLABS SHOULD BE REMOVED IN THEIR ENTIRETY, AND NOT REUSED ON THE SITE.

VEGETATIVE COVER SEED MIXTURE SCHEDULE*

PLANTING ELEVATION	SCIENTIFIC NAME	COMMON NAME	PERCENTAGE OF MIX	APPLICATION RATE	PLANTING PERIOD
ALL DISTURBED AREAS OF SITE	SECALE CEREALE	GRAIN RYE	40.00%	75 LBS/ 1 ACRE (MIX INCLUDING GRAIN COVER CROP)	AUGUST 1 - FEB. 15 **
	SORGHASTRUM NUTANS	INDIAN GRASS	20.80%		
	ANDROPOGON GERARDII	BIG BLUESTEM	11.20%		
	ELYMUS VIRGINICUS	VIRGINIA WILD RYE	11.20%		
	ELYMUS CANADENSIS	CANADA WILD RYE	5.60%		
	PANICUM VIRGATUM	SWITCHGRASS	3.10%		
	PANICUM CLANDESTINUM	DEERTONGUE	2.40%		
	ECHINACEA PURPUREA	PURPLE CONEFLOWER	1.20%		
	CHAMAECRISTA FASCICULATA	PARTRIDGE PEA	1.10%		
	HELIOPSIS HELIANTHOIDES	OXEYE SUNFLOWER	0.90%		
	COREOPSIS LANCEOLATA	LANCELEAF COREOPSIS	0.80%		
	RUDBECKIA HIRTA	BLACKEYED SUSAN	0.80%		
	MONARDA FISTULOSA	WILD BERGAMOT	0.30%		
	ASLEPIAS SYRIACA	COMMON MILKWEED	0.20%		
	SOLIDAGO RUGOSA	WRINKLELEAF GOLDENROD	0.20%		
	ASTER LATERIFLORUS	CALICO ASTER	0.10%		
ASTER PILOSUS	HEATH ASTER	0.10%			

- NOTES:**
- *1. PROVIDE "NATIVE STEEP SLOPE MIX WITH GRAIN RYE", ERNMX-181-2, AS MANUFACTURED BY ERNST SEEDS, OR APPROVED EQUAL.
 - **2. FOR SEEDING PERIOD FEB. 15-JULY 31, PROVIDE NATIVE STEEP SLOPE MIX WITH GRAIN OATS", ERNMX-181-1, AS MANUFACTURED BY ERNST SEEDS OR APPROVED EQUAL.

SOIL AMENDMENT NOTES:

1. PROVIDE SOIL TESTING A MINIMUM OF THREE MONTHS PRIOR TO SEEDING OPERATIONS TO DETERMINE FINAL SOIL AMENDMENT REQUIREMENTS. TESTING SHALL INCLUDE LEVELS OF MACRO-AND MICRO-NUTRIENTS, SOIL pH, PERCENTAGE ORGANIC MATTER CONTENT, AND VEGETATION ESTABLISHMENT REPORT.
 - A. PROVIDE ONE REPRESENTATIVE SOIL TEST FOR EVERY 10 ACRES OF SEEDING AREA
2. SOIL AMENDMENTS FOR SEEDING VEGETATIVE COVER SEED MIX (SANDY SOILS):
 - A. FERTILIZER: 14-0-14 WITH 70% WN AND A MINIMUM 8% HUMIC ACID (DERIVED FROM LEONARDITE)
 - 1) STANDARD OF QUALITY: LEBANON TURF 14-0-14 70% MESA SOP+11.2% HUMIC MAX
 - 2) APPLICATION RATE: TO SUPPLY 1LB. OF NITROGEN PER 1,000 SQ FT
 - B. LIME APPLICATION: 30-60 LBS PER 1000 SQ FT (0.6 -1.25 TONS PER ACRE), AS DETERMINED BY SOIL TESTING
3. SOIL AMENDMENT PROCEDURES SHALL COMPLY WITH NYSDEC REGULATIONS GOVERNING FERTILIZER AND SOIL AMENDMENT APPLICATION.

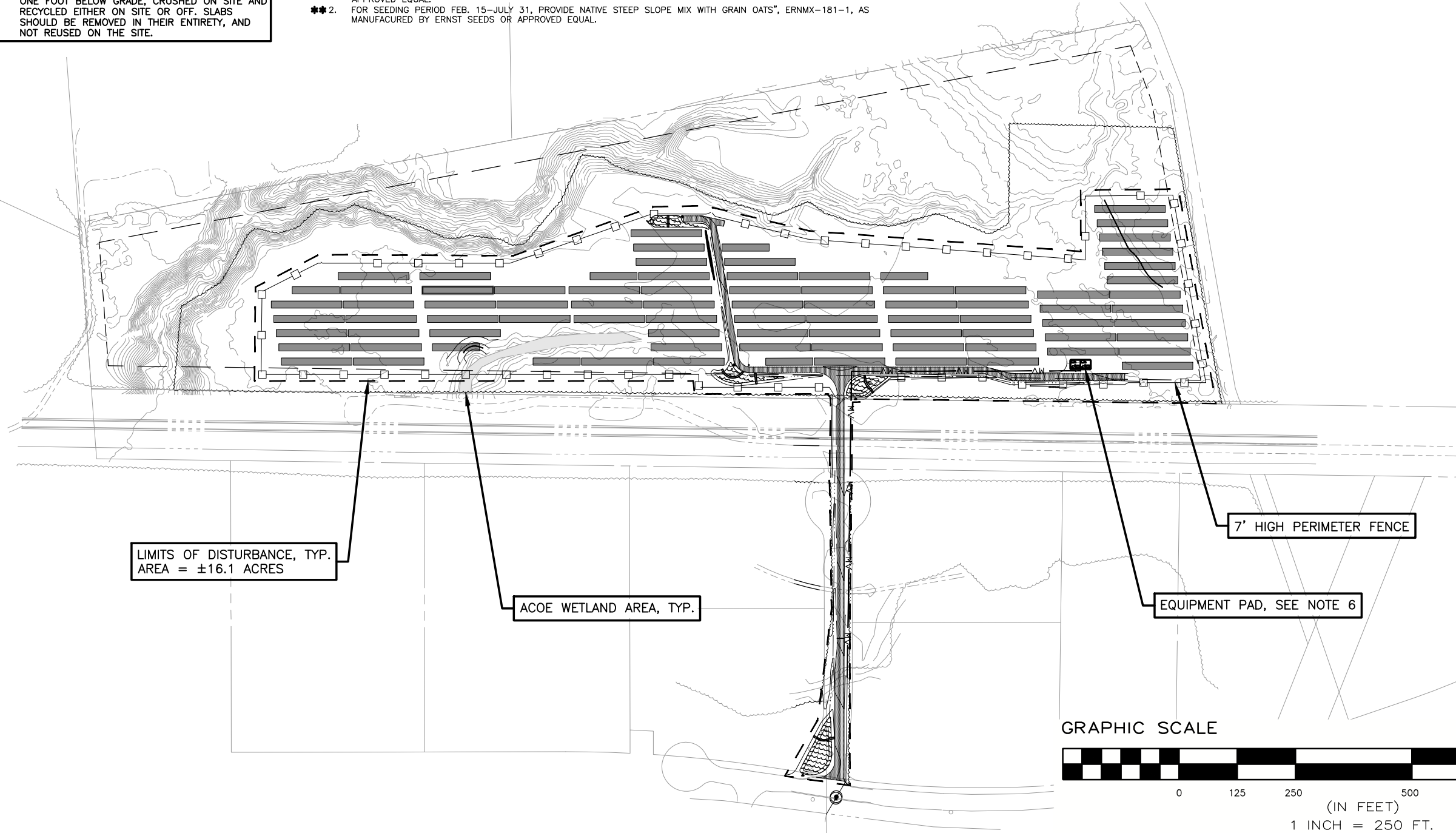

SOLAR PROJECT
BAKERS FALLS SOLAR,
LLC

11-15 ELECTRIC DRIVE
 TOWN OF MOREAU
 SARATOGA COUNTY, NEW YORK

REVISION	DATE	BY

SCALE: 1"=250'

SHEET TITLE: DECOMMISSIONING PLAN

FIGURE 1 OF 1

ENVIRONMENTAL DESIGN
PARTNERSHIP, LLP.
 900 Route 146 Clifton Park, New York 12065
 (518) 371-7621
 edplp.com